

# EYEBOLT AN42 Thru AN49

Rated Strength-Pounds

AN#	Size	E		Pin Size	Tensile Strength of eye	Yield Strength of eye
		Min	Max			
AN42B	10-32	.190	.192	3/16	1,150	880
AN43B	1/4-28	.190	.192	3/16	2,450	1,880
AN44	5/16-24	.250	.253	1/4	3,910	3,000
AN45	5/16-24	.313	.316	5/16	5,290	4,055
AN46	3/8-24	.375	.378	3/8	7,015	5,375
AN47	7/16-20	.375	.378	3/8	9,200	7,055
AN48	1/2-20	.375	.441	7/16	14,375	11,020
AN49	9/16-18	.500	.503	1/2	20,125	15,430

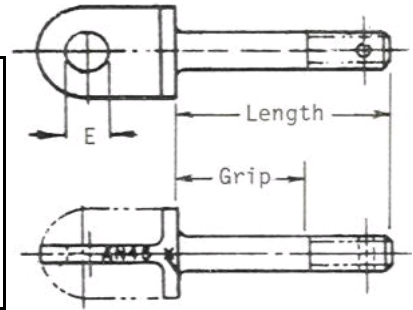

Refer to AN3-AN9 Chart for length Data and Dash Numbers.

# CLEVIS BOLT AN21 Thru AN36

Rated Strength- Pounds

AN#	Size	Shear	Tensile	AN#	Size	Shear	Tensile
AN21	6-40	1,060	510	AN28	1/2-20	14,700	9,250
AN22	8-32	1,050	760	AN29	9/16-18	18,700	11,800
AN23	10-32	2,125	1,105	AN30	5/8-18	23,000	15,050
AN24	1/4-28	3,680	2,040	AN32	3/4-16	33,150	22,000
AN25	5/16-24	5,750	3,250	AN34	7/8-14	45,050	30,000
AN26	3/8-24	8,280	5,050	AN37	1-12	58,900	40,350
AN27	7/16-20	11,250	6,800				

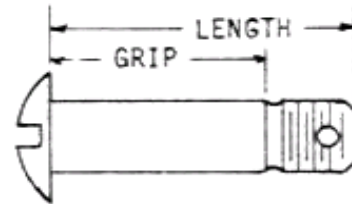

Dash #	AN23 (10-32)	AN24 (1/4-28)	AN25 (5/16-24)	AN26 (3/8-24)	AN27 (7/16-20)
	Grip Length	Grip Length	Grip Length	Grip Length	Grip Length
-8	3/16 17/32	3/16 17/32			
-9	1/4 19/32	1/4 19/32	1/4 39/34	1/4 39/34	
-10	5/16 21/32	5/16 21/32	5/16 43/64	5/16 43/64	
-11	3/8 23/32	3/8 23/32	3/8 47/64	3/8 47/64	
-12	7/16 25/32	7/16 25/32	7/16 51/64	7/16 51/64	3/8 51/64
-13	1/2 27/32	1/2 27/32	1/2 55/64	1/2 55/64	7/16 55/64
-14	9/16 29/32	9/16 29/32	9/16 59/64	9/16 59/64	1/2 59/64
-15	5/8 31/32	5/8 31/32	5/8 63/34	5/8 63/34	9/16 63/34
-16	11/16 1-1/32	11/16 1-1/32	11/16 1-3/64	11/16 1-3/64	5/8 1-3/64
-17	3/4 1-3/32	3/4 1-3/32	3/4 1-7/64	3/4 1-7/64	11/16 1-7/64
-18	13/16 1-5/32	13/16 1-5/32	13/16 1-11/64	13/16 1-11/64	3/4 1-11/64
-19	7/8 1-7/32	7/8 1-7/32	7/8 1-15/64	7/8 1-15/64	13/16 1-15/64
-20	15/16 1-9/32	15/16 1-9/32	15/16 1-19/64	15/16 1-19/64	7/8 1-19/64
-21	1 1-11/32	1 1-11/32	1 1-23/64	1 1-23/64	15/16 1-23/64
-22	1-1/16 1-13/32	1-1/16 1-13/32	1-1/16 1-27/64	1-1/16 1-27/64	1 1-27/64
-23	1-1/8 1-15/32	1-1/8 1-15/32	1-1/8 1-31/64	1-1/8 1-31/64	1-1/16 1-31/64
-24	1-3/16 1-17/32	1-3/16 1-17/32	1-3/16 1-35/64	1-3/16 1-35/64	1-1/8 1-35/64
-25	1-1/4 1-19/32	1-1/4 1-19/32	1-1/4 1-39/64	1-1/4 1-39/64	1-3/16 1-39/64
-26	1-5/16 1-21/32	1-5/16 1-21/32	1-5/16 1-43/64	1-5/16 1-43/64	1-1/4 1-43/64
-27	1-3/8 1-23/32	1-3/8 1-23/32	1-3/8 1-47/64	1-3/8 1-47/64	1-5/16 1-47/64
-28	1-7/16 1-25/32	1-7/16 1-25/32	1-7/16 1-51/64	1-7/16 1-51/64	1-3/8 1-51/64
-29	1-1/2 1-27/32	1-1/2 1-27/32	1-1/2 1-55/64	1-1/2 1-55/64	1-7/16 1-55/64
-30	1-9/16 1-29/32	1-9/16 1-29/32	1-9/16 1-59/64	1-9/16 1-59/64	1-1/2 1-59/64
-31	1-5/8 1-31/32	1-5/8 1-31/32	1-5/8 1-63/64	1-5/8 1-63/64	1-9/16 1-63/64
-32	1-11/16 2-1/32	1-11/16 2-1/32	1-11/16 2-3/64	1-5/8 2-3/64	1-5/8 2-3/64
.34	1-13/16 2-5/32	1-13/16 2-5/32	1-13/16 2-11/64	1-13/16 2-11/64	1-3/4 2-11/64
.36	1-15/16 2-9/32	1-15/16 2-9/32	1-15/16 2-19/64	1-15/16 2-19/64	1-7/8 2-19/64
.38	2-1/16 2-13/32	2-1/16 2-13/32	2-1/16 2-27/64	2-1/16 2-27/64	2 2-27/64
.40	2-3/16 2-17/32	2-3/16 2-17/32	2-3/16 2-35/64	2-3/16 2-35/64	2-1/8 2-35/64